



Thomas SR 71

Precision. Power. Performance.

You want a trusted name when it comes to providing engineered power transmission products that improve productivity and efficiency. Rexnord provides superior products for your industrial applications world wide. We work closely with you to reduce maintenance costs, eliminate redundant inventories and prevent equipment downtime.

Applications include:

- ▶ pumps
- ▶ compressors
- ▶ industrial fans
- ▶ paper machines

Thomas SR 71

Spacer style flexible metallic disc coupling designed for your pump and compressor applications. The simple three piece design and piloted center member provide fast installation and repeatable balance significantly reducing your installation and service time. The six bolt style offers high misalignment and large axial capacity.

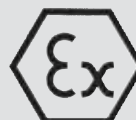

Thomas SR 71

Features

- ▶ Unitized and piloted center member
- ▶ Bolt on hubs
- ▶ Jacking bolt feature

Benefits

- ▶ Ease of installation
- ▶ Repeatable balance
- ▶ Meets API Specifications
- ▶ Oversize bore capacity
- ▶ Ease of installation

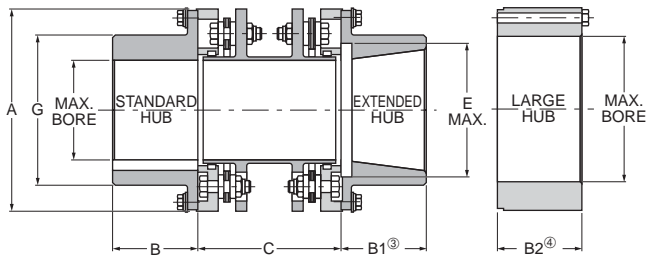
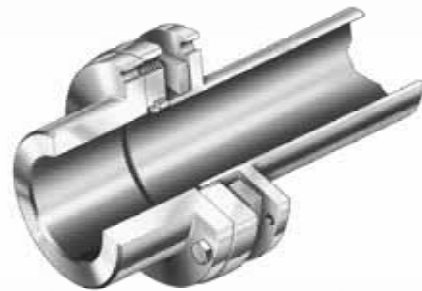

Torque Demands Driven Machine	Typical Application for Electric Motor or Turbine Driven Equipment	Typical Service Factor
	Constant torque such as centrifugal pumps blowers and compressors	1.0
	Continuous duty with some torque variations including plastic extruders and forced draft fans	1.5
	Light shock loads from metal extruders, cooling towers and log haulers	2.0
	Moderate shock loading as expected from a car dumper, stone crusher, vibrating screen	2.5
	Heavy shock load with some negative torques from reciprocating pumps, compressors, reversing turnout tables	3.0
	Frequent torque reversals such as reciprocating compressors with frequent torque reversals which do not necessarily include reverse rotations	Consult Rexnord Engineering

General Dimensions (mm)

Coupling Size	Stocked „C“ Dimensions			B & B1 Hub Max Bore (mm)	B2 Hub Max Bore (mm)	A (mm)	B (mm)	B1 (mm)	B2 (mm)	Min C (mm)	Max E (mm)	G (mm)
	140 (mm)	180 (mm)	250 (mm)									
150	•			39	64	91	33,3	42,9	41,1	87	52	59
175	•			50	73	106	39,6	52,3	46,0	87	65	71
225	•	•	•	58	87	125	50,8	63,5	52,3	87	78	85
300		•	•	81	110	152	66,5	82,6	69,9	102	105	113
350		•	•	95	120	171	79,2	95,3	76,2	124	127	133
375		•	•	100	137	194	82,6	101,6	82,6	127	135	144
412			•	110	145	203	91,9	111,3	91,9	155	146	155
462			•	130	166	229	104,6	127,0	104,6	178	160	174
512			•	140	187	255	114,3	136,7	114,3	191	179	194
562				156	200	279	127,0	152,4	127,0	203	195	213
600				166	220	298	133,4	162,1	133,4	229	211	227

Engineering data

Coupling Size	Max RPM		Max Continuous Torque (Nm)	Peak Overload Torque (Nm)	Weight (Kg.)	WR ² (kgm ²)	Weight Change Per m of „C“ (Kg.)	WR ² Change Per mm of „C“ (kgm ² /m)	Axial Capacity (mm)
	Not Balanced	Balanced							
150	9 000	20 800	105	210	3,0	0,0031	1,79	0,0003	±0,12
175	8 300	17 000	184	368	4,3	0,0060	2,50	0,001	±0,17
225	7 700	16 000	345	691	6,4	0,0123	3,40	0,003	±0,19
300	6 800	14 000	820	1 639	11,8	0,0354	4,65	0,008	±2,15
350	6 200	13 500	1 513	3 026	19,5	0,0758	7,51	0,014	±2,29
375	5 650	12 000	2 179	4 358	25,0	0,1238	7,69	0,019	±2,41
412	5 350	11 000	2 540	5 080	32,2	0,1799	10,72	0,033	±2,79
462	5 000	10 000	4 561	9 122	45,9	0,1799	14,30	0,054	±3,04
512	4 700	9 200	6 209	12 418	61,3	0,3248	18,59	0,086	±3,30
562	4 350	8 300	9 494	18 988	84,4	0,5355	22,88	0,120	±3,68
600	4 150	7 800	10 352	20 704	103,5	1,2436	31,28	0,202	±4,06



REXNORD NV, Belgium

Dellingstraat 55

2800 Mechelen

Phone: +32 / 70 22 33 66

Fax: +32 / 70 22 33 67

E-mail: Customerservice.Belgium@rexnord.com

www.rexnord.eu

Contact